



Longcrofte Road

Edgware

£549,950

A two bedroom, two bathroom flat available chain free in an excellent location with Davidson Frost-Wellings.

The flat is available with a large reception room with French doors leading to a private patio and large communal gardens. The flat also benefits from a separate kitchen, large master bedroom with built-in wardrobes and an ensuite shower room, an second double bedroom, a family bathroom and built in storage.

Bartholomew Court is available with private, gated parking and bays for visitors.

Leasehold with approximately 97 years left.

Ground rent of £400 per annum.

Service charge of £2588 per annum.

Harrow council Tax band F.

- Two bedrooms
- Two bathrooms
- Chain free
- Private patio
- Secure parking
- Leasehold

Viewing

Please contact our Davidson Frost-Wellings Office on 020 8954 8806 if you wish to arrange a viewing appointment for this property or require further information.



Floor Plan

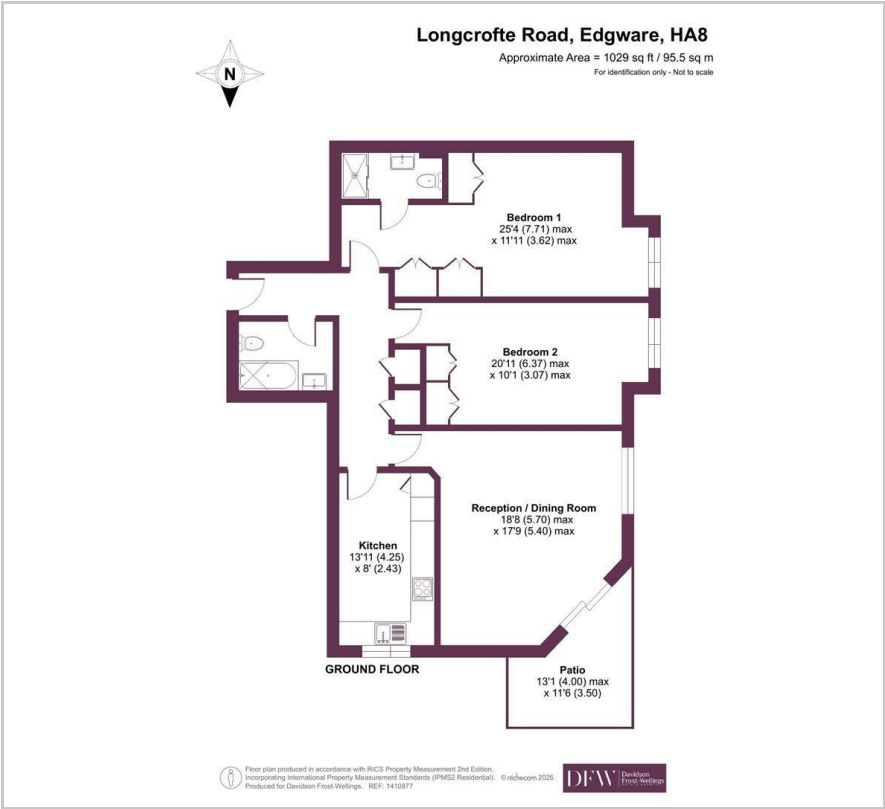

Area Map

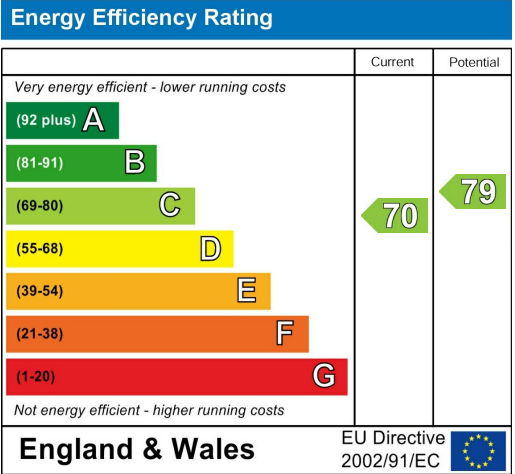

These particulars, whilst believed to be accurate are set out as a general outline only for guidance and do not constitute any part of an offer or contract. Intending purchasers should not rely on them as statements of representation of fact, but must satisfy themselves by inspection or otherwise as to their accuracy. No person in this firms employment has the authority to make or give any representation or warranty in respect of the property.